

INSTALLATION FIXTURE  
HOLDS MOUNT WHILE  
ADHESIVE CURES.

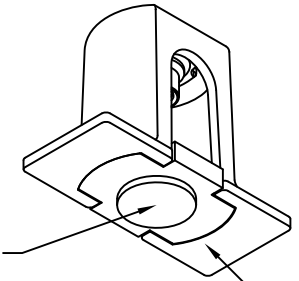

MOUNT ATTACHED BY  
ADHESIVE APPLIED TO  
THIS SURFACE.

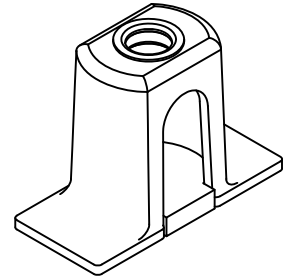

NUT AND RETAINER MATERIAL AND FINISH DATA

CODE	NUT MATERIAL	SPEC.	DRI-FILM LUBE	RETAINER MATERIAL	SPEC.	PASSIVATE
CR	A-286 CRES	AMS 5525	AS5272	A-286, 304, 305 CRES	AMS 5525, 5639, 5514	AMS 2700

BASEPLATE MATERIAL

CODE	MATERIAL
U	GLASS/PEI, 30% GLASS
UC	CARBON/PEI, 30% CARBON
V	GLASS/PEI, 40% GLASS
VC	CARBON/PEI, 40% CARBON

LENGTH L DATA

CODE	L
8	.500
12	.750
16	1.000
24	1.500
32	2.000

THREAD DATA AND RECOMMENDED SCREW TIGHTENING TORQUE

CODE	THREAD SIZE	SPEC.	INSTALLATION TORQUE (IN-LBS)
08	.1640-32 UNJC-3B	AS8879	15-20
3	.1900-32 UNJF-3B		25-35
4M	MJ4 X 0,7 4H6H	ISO 5855	15-20
5M	MJ5 X 0,8 4H6H		25-35

OPTIONAL BASEPLATE PRIMER

CODE	MATERIAL SPEC.
P	MIL-PRF-85582

RADIAL FLOAT OF NUT .030 MIN FROM CENTER.  
SCREW CAN ENGAGE MAX MISALIGNED NUT.  
THREAD LOCK BY ELLIPTICAL DEFORMATION.

STRENGTH REQUIREMENT: WILL WITHSTAND  
A 50 LB LOAD APPLIED IN ANY DIRECTION.

EXAMPLE PART NUMBER

CB4523 V 3 CR 16 P

↑ BASIC PART NUMBER  
↑ BASEPLATE MATERIAL - GLASS/PEI  
↑ THREAD SIZE - .1900-32 UNJF-3B  
↑ NUT AND RETAINER MATERIAL - A-286, 304, 305 CRES  
↑ LENGTH L - 1.00  
↑ OPTIONAL PRIMER

UNLESS OTHERWISE SPECIFIED, ALL DIMENSIONS ARE IN INCHES AND TOLERANCES ARE AS SHOWN BELOW. DIMENSIONAL TOLERANCES AND SYMBOLS PER ANSI Y14.5M-1982.

PROPRIETARY PARTS SHOWN IN THIS DRAWING ARE THE SUBJECT OF ISSUED UNITED STATES AND FOREIGN PATENTS AND PATENTS PENDING. UNAUTHORIZED REPRODUCTION AND/OR DISTRIBUTION OF THIS DRAWING IS SPECIFICALLY PROHIBITED.

**CLICK BOND**

CARSON CITY  
NEVADA 89706

APPROVALS		DATE	TITLE				
ANGLES	±1°	DRAWN <b>BPEREZ</b>	8JUL13	NUTPLATE, STANDOFF, COMPOSITE, INTERNALLY FIXTURED			
.XX	±.03	CHECKED <b>JAC</b>	8JUL13	SIZE	CAGE CODE	DWG. NO.	REV.
.XXX	±.010	RELEASED <b>ABC</b>	8JUL13	A	66530	CB4523	0
.XXXX	±.001	REVISED		SCALE	1/1	8JUL13	SHEET 1 OF 1